

WATERTOWN
ROUTE 16 (MOUNT AUBURN STREET)

| | | | |
|------------------|-----------------------|-----------|--------------|
| STATE | FED. AID PROJ. NO. | SHEET NO. | TOTAL SHEETS |
| MA | STP/CMQ/HSI-0036(017) | 136 | 391 |
| PROJECT FILE NO. | | 607777 | |

TRAFFIC SIGN & PAVEMENT MARKING PLANS
SHEET 10 OF 18

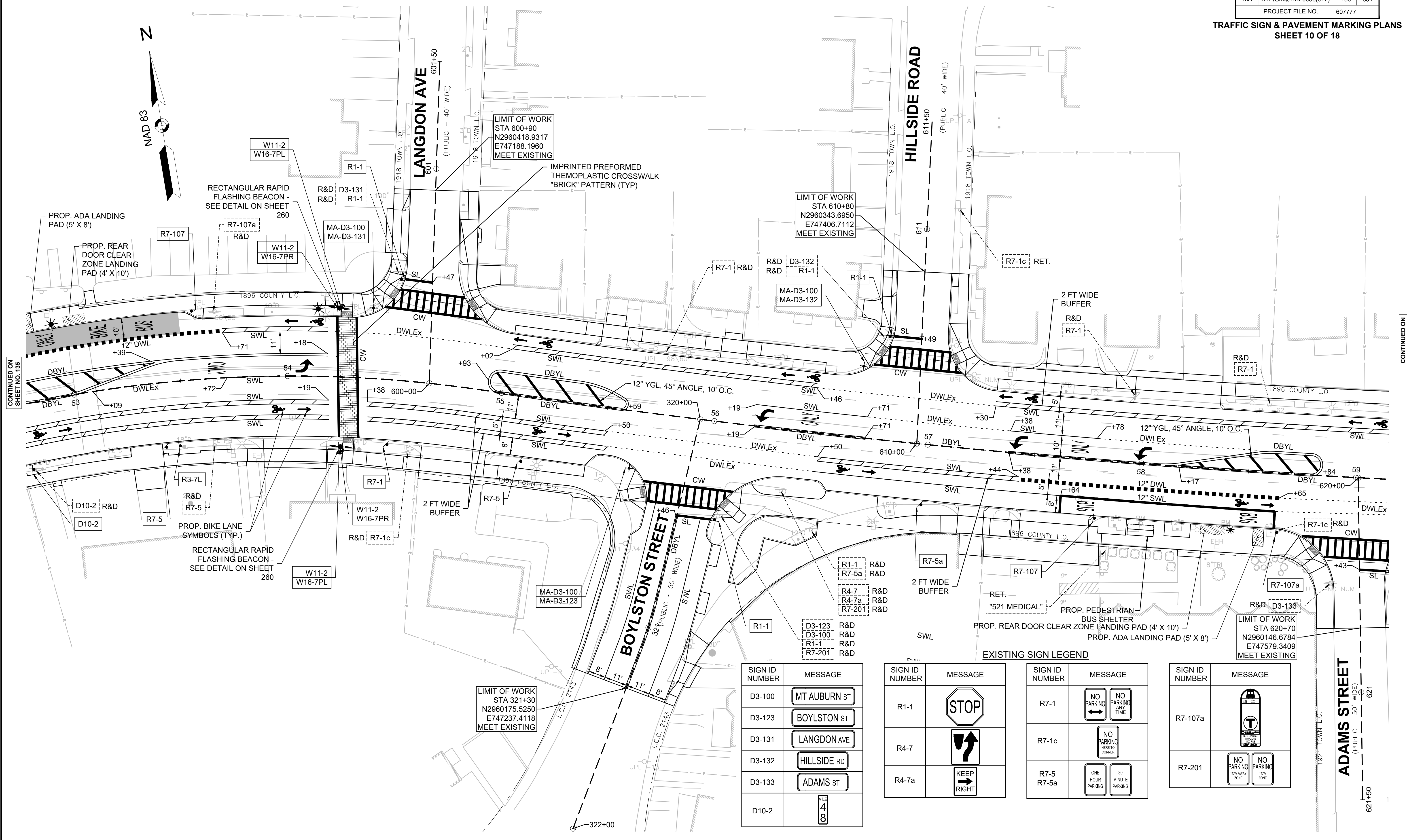
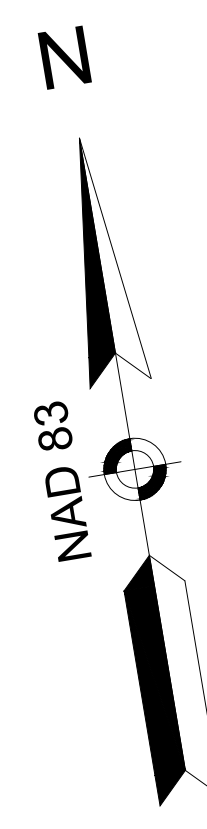

CONTINUED ON SHEET NO. 135

CONTINUED ON SHEET NO. 137

LIMIT OF WORK
STA 321+30
N2960175.5250
E747237.4118
MEET EXISTING

LIMIT OF WORK
STA 610+80
N2960343.6950
E747406.7112
MEET EXISTING

LIMIT OF WORK
STA 620+70
N2960146.6784
E747579.3409
MEET EXISTING

| SIGN ID NUMBER | MESSAGE |
|----------------|--------------|
| D3-100 | MT AUBURN ST |
| D3-123 | BOYLSTON ST |
| D3-131 | LANGDON AVE |
| D3-132 | HILLSIDE RD |
| D3-133 | ADAMS ST |
| D10-2 | 48 |

| SIGN ID NUMBER | MESSAGE |
|----------------|-------------|
| R1-1 | STOP |
| R4-7 | UPWARD TURN |
| R4-7a | KEEP RIGHT |

| SIGN ID NUMBER | MESSAGE |
|----------------|--------------------------------------|
| R7-1 | NO PARKING ANY TIME |
| R7-1c | NO PARKING FIRE TO CORNER |
| R7-5 R7-5a | ONE HOUR PARKING / 30 MINUTE PARKING |

| SIGN ID NUMBER | MESSAGE |
|----------------|--------------------------|
| R7-107a | PEDESTRIAN BUS SHELTER |
| R7-201 | NO PARKING TOW AWAY ZONE |

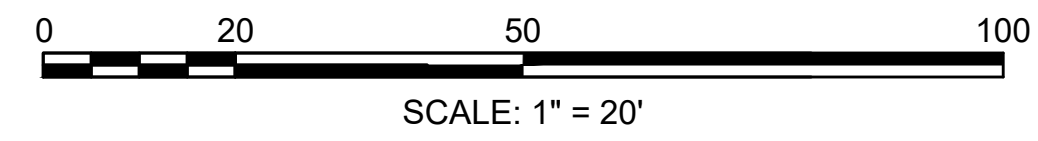

WATERTOWN
ROUTE 16 (MOUNT AUBURN STREET)

| STATE | FED. AID PROJ. NO. | SHEET NO. | TOTAL SHEETS |
|-------------------------|-----------------------|-----------|--------------|
| MA | STP/CMQ/HSI-0036(017) | 137 | 391 |
| PROJECT FILE NO. 607777 | | 607777 | |

TRAFFIC SIGN & PAVEMENT MARKING PLANS
SHEET 11 OF 18

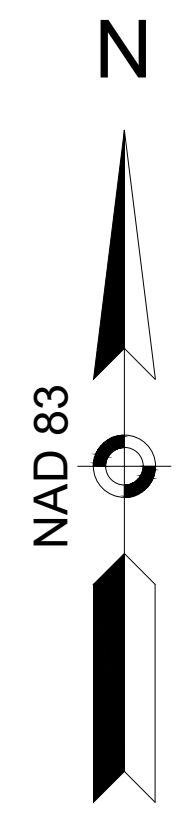

EXISTING SIGN LEGEND

| SIGN ID NUMBER | MESSAGE | SIGN ID NUMBER | MESSAGE |
|----------------|---------------------------|----------------|---------|
| D3-133 | ADAMS ST | R7-107 | |
| D3-134 | DEXTER AVE | R7-107a | |
| D3-135 | UPLAND RD | R10-6 | |
| R1-1 | STOP | | |
| R7-1 | NO PARKING | | |
| R7-1c | NO PARKING HERE TO FORMER | | |

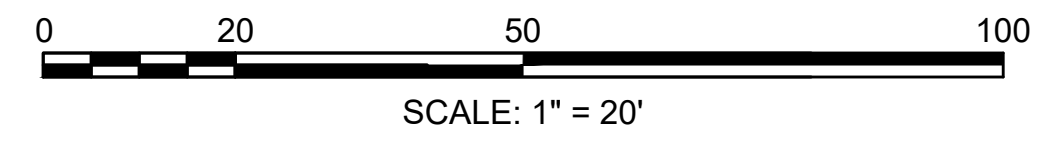
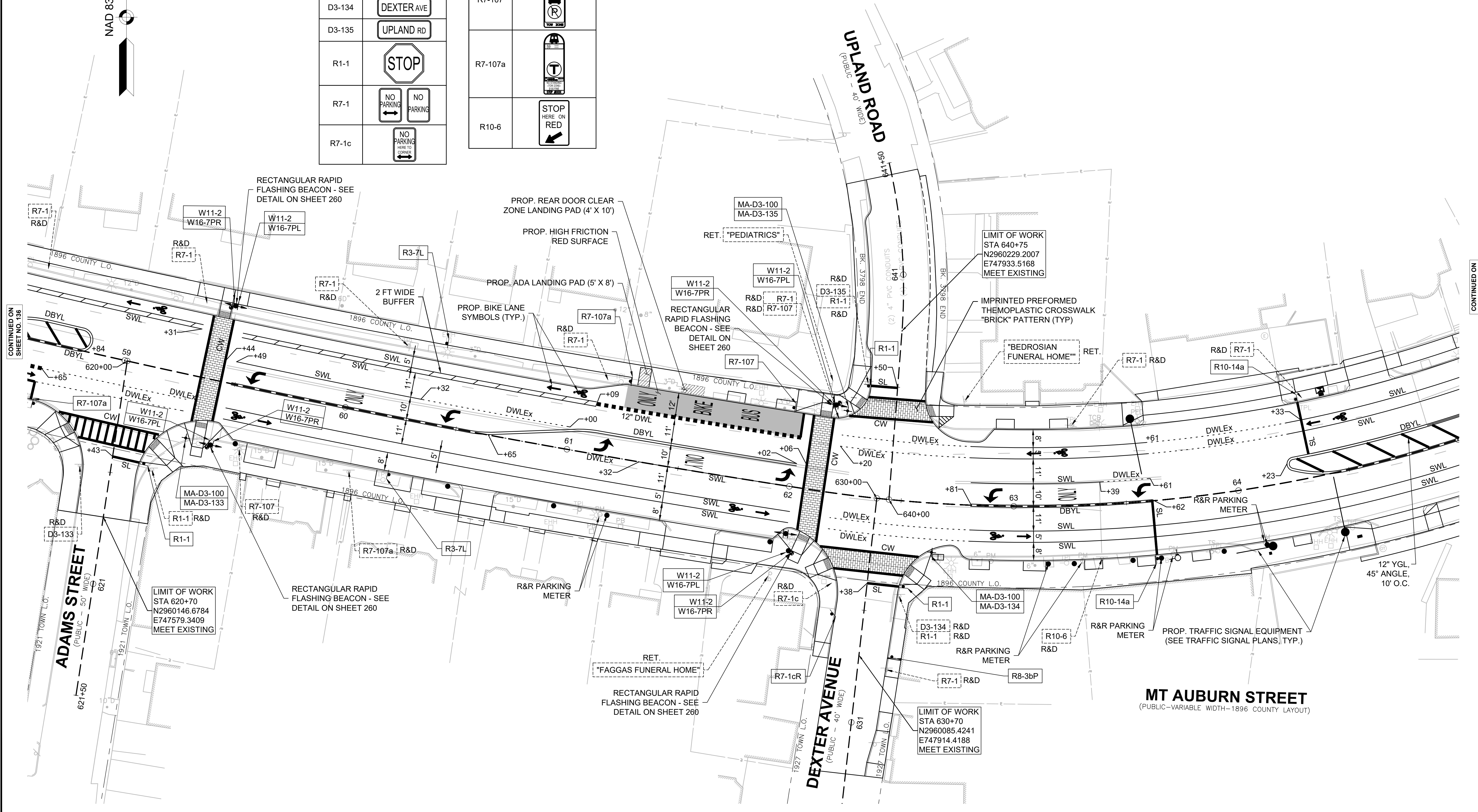

CONTINUED ON SHEET NO. 136

CONTINUED ON SHEET NO. 138

607777_HDP(PAVEMENT MARKING PLANS).DWG Plotted on 9/5/2023 6:52 PM

EXISTING SIGN LEGEND

| SIGN ID NUMBER | MESSAGE |
|----------------|-------------|
| D3-136 | MELENDY AVE |
| D3-137 | LLOYD RD |
| D3-138 | ELTON AVE |
| D3-139 | IRMA AVE |
| D3-140 | BIGELOW AVE |
| D3-141 | WELLS AVE |
| D3-142 | KIMBALL RD |
| OM1-1 | |

| SIGN ID NUMBER | MESSAGE |
|----------------|--------------|
| R1-1 | STOP |
| R3-4 | |
| R4-7 | |
| R5-1 | DO NOT ENTER |
| R6-1 | ONE WAY |

| SIGN ID NUMBER | MESSAGE |
|---------------------------|------------------------------------------------------------------|
| R7-1 | NO PARKING |
| R7-1cL R7-1c R7-1cR | NO PARKING SIDE TO CORNER SIDE TO CORNER SIDE TO CORNER |
| R7-8 | RESERVED PARKING |
| R7-107 | |

| SIGN ID NUMBER | MESSAGE |
|----------------|---------------------------|
| R7-107a | |
| R7-201 | NO PARKING TOW ZONE |
| R10-7 | DO NOT BLOCK INTERSECTION |
| W11-2 | |

WATERTOWN
ROUTE 16 (MOUNT AUBURN STREET)

| STATE | FED. AID PROJ. NO. | SHEET NO. | TOTAL SHEETS |
|-------|-----------------------|-----------|--------------|
| MA | STP/CMQ/HSI-0036(017) | 138 | 391 |

PROJECT FILE NO. 607777
TRAFFIC SIGN & PAVEMENT MARKING PLANS
SHEET 12 OF 18

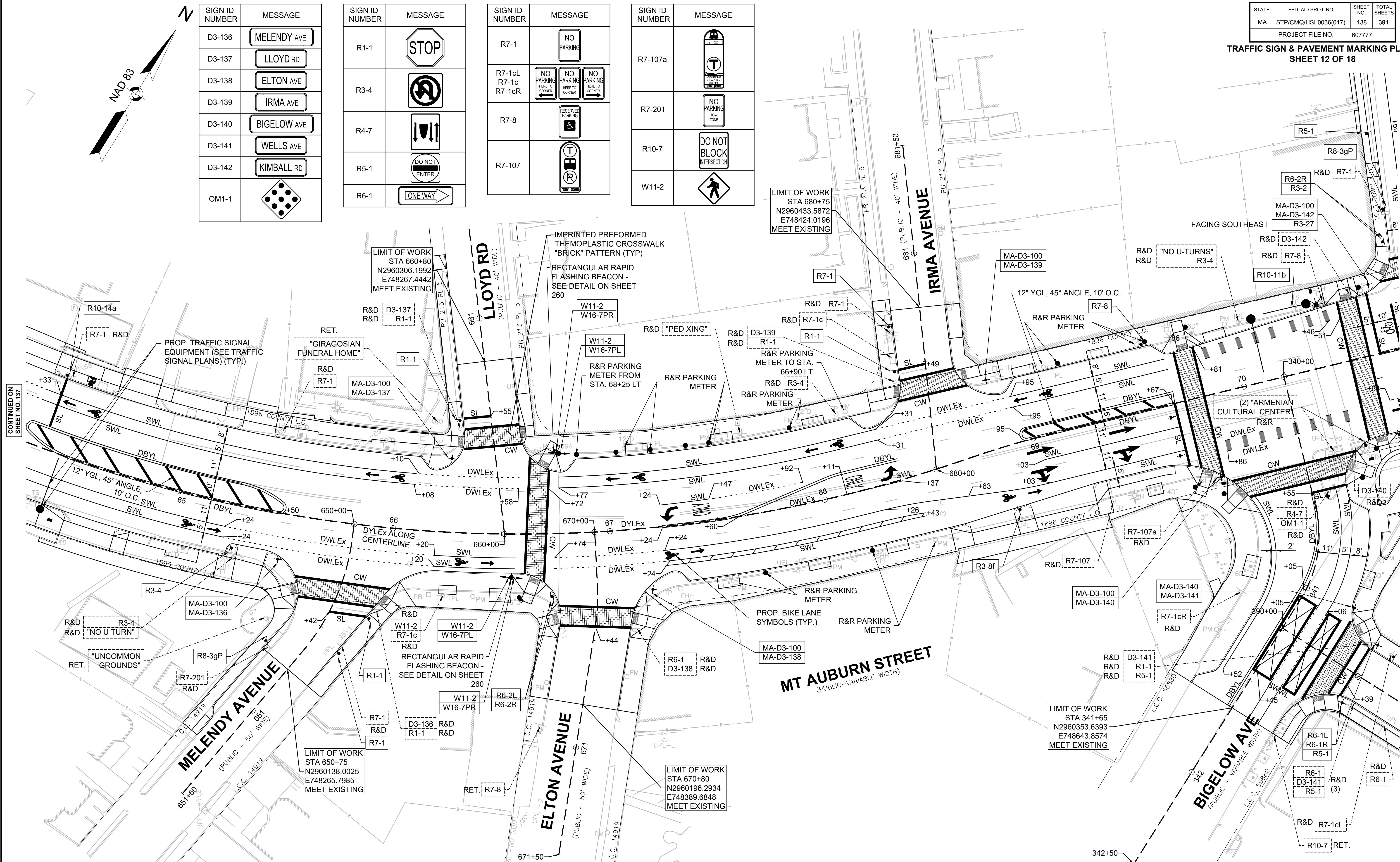

CONTINUED ON SHEET NO. 137

CONTINUED ON SHEET NO. 139

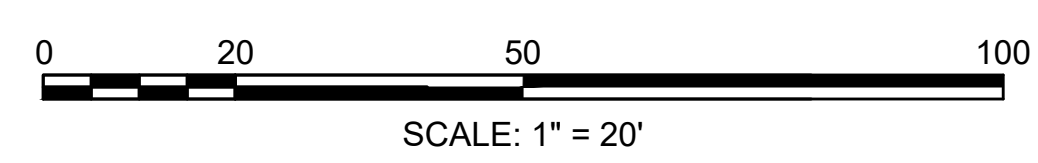

EXISTING SIGN LEGEND

| SIGN ID NUMBER | MESSAGE | SIGN ID NUMBER | MESSAGE | SIGN ID NUMBER | MESSAGE |
|----------------|---------|----------------|---------|----------------|---------|
| R7-8 | | R7-107a | | R10-7 | |
| | | R7-107 | | R10-11b | |

WATERTOWN
ROUTE 16 (MOUNT AUBURN STREET)

| | | | |
|-------------------------|-----------------------|-----------|--------------|
| STATE | FED. AID PROJ. NO. | SHEET NO. | TOTAL SHEETS |
| MA | STP/CMQ/HSI-0036(017) | 139 | 391 |
| PROJECT FILE NO. 607777 | | | |

TRAFFIC SIGN & PAVEMENT MARKING PLANS
SHEET 13 OF 18

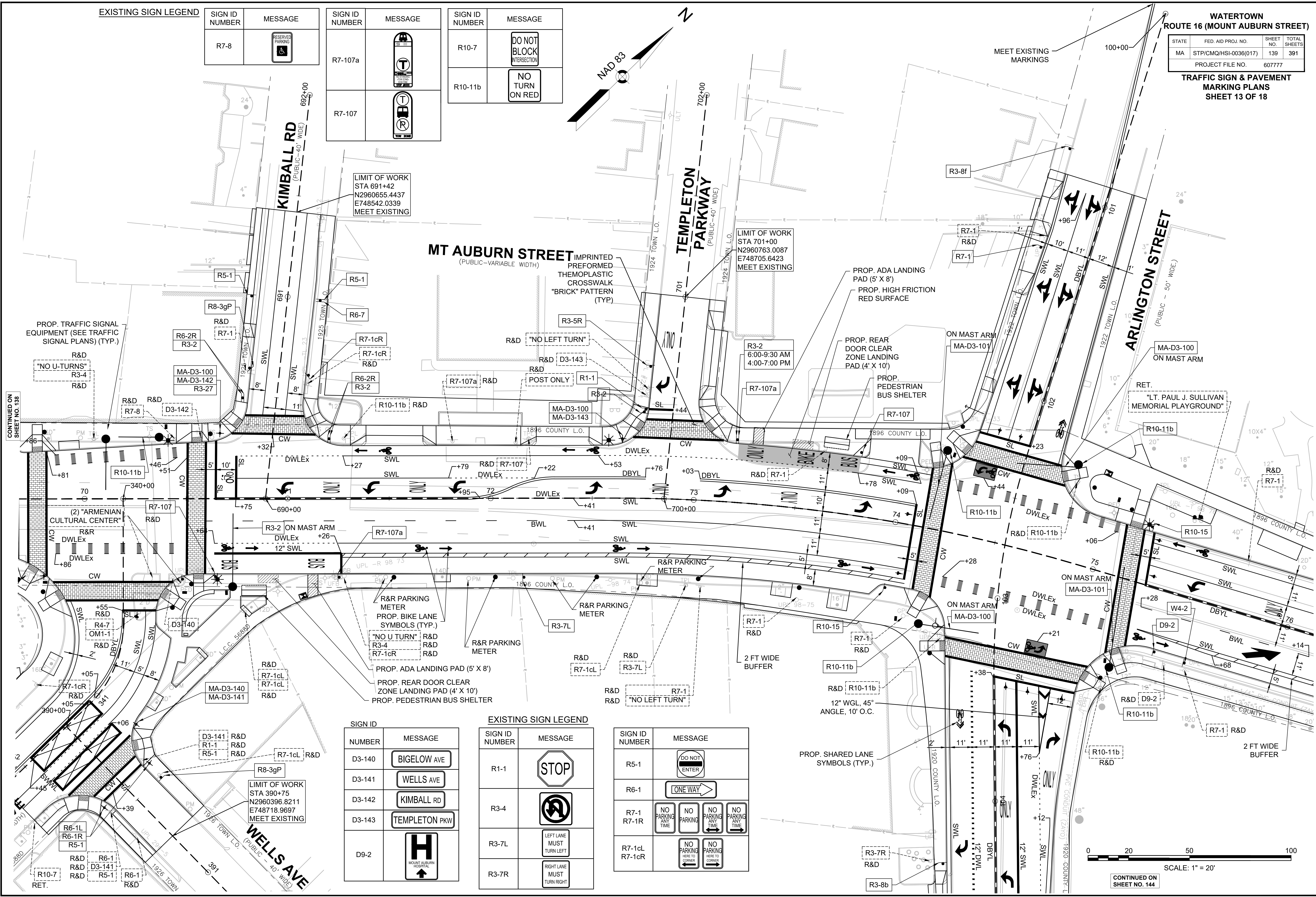

EXISTING SIGN LEGEND

| SIGN ID NUMBER | MESSAGE |
|----------------|---------|
| D3-140 | |
| D3-141 | |
| D3-142 | |
| D3-143 | |
| D9-2 | |

EXISTING SIGN LEGEND

| SIGN ID NUMBER | MESSAGE |
|----------------|---------|
| R1-1 | |
| R3-4 | |
| R3-7L | |
| R3-7R | |

EXISTING SIGN LEGEND

| SIGN ID NUMBER | MESSAGE |
|----------------|---------|
| R5-1 | |
| R6-1 | |
| R7-1 | |
| R7-1R | |
| R7-1cL | |
| R7-1cR | |

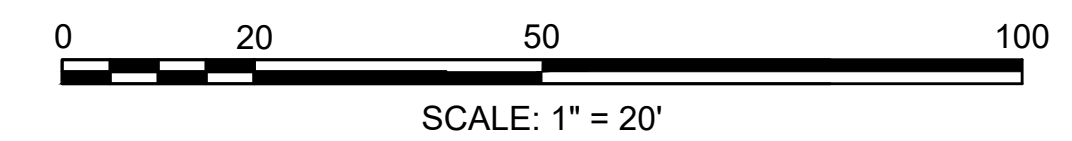

CONTINUED ON SHEET NO. 138

CONTINUED ON SHEET NO. 140

CONTINUED ON SHEET NO. 144

**WATERTOWN
ROUTE 16 (MOUNT AUBURN STREET)**

| | | | |
|------------------|-----------------------|-----------|--------------|
| STATE | FED. AID PROJ. NO. | SHEET NO. | TOTAL SHEETS |
| MA | STP/CMQ/HSI-0036(017) | 140 | 391 |
| PROJECT FILE NO. | | 607777 | |

**TRAFFIC SIGN & PAVEMENT MARKING PLANS
SHEET 14 OF 18**

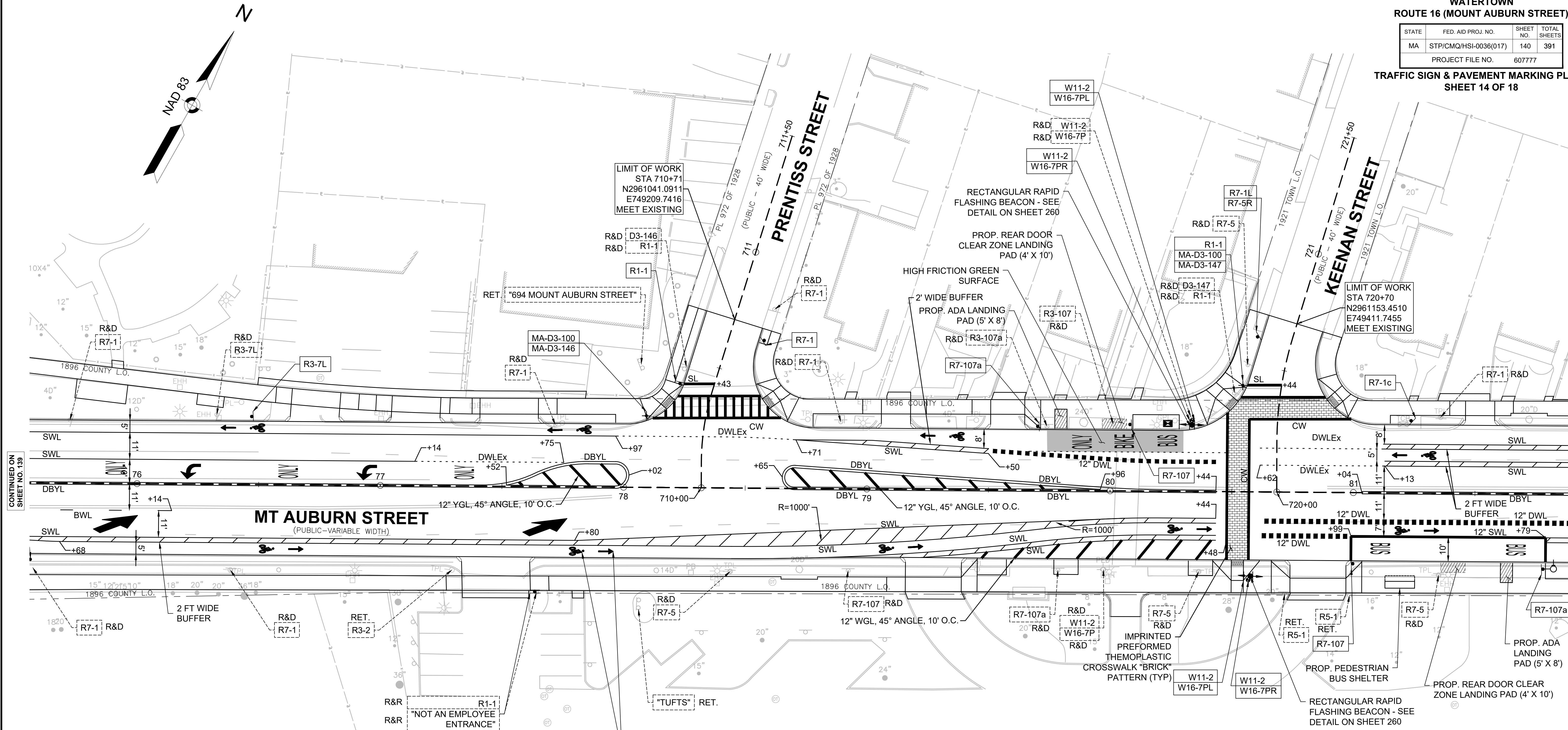

CONTINUED ON
SHEET NO. 139

CONTINUED ON
SHEET NO. 141

607777_HDP(AVEMENT MARKING PLANS).DWG
Plotted on: 9/5/2023 6:54 PM

EXISTING SIGN LEGEND

| SIGN ID NUMBER | MESSAGE | SIGN ID NUMBER | MESSAGE | SIGN ID NUMBER | MESSAGE |
|----------------|--------------------------|----------------|---------------------------------------------------------|----------------|---------------------|
| MA-D3-146 | PRENTISS ST | R5-1 | DO NOT ENTER | R7-107a | TRUCK STOP |
| MA-D3-147 | KEENAN ST | R7-1 | NO PARKING THIS SIDE / NO PARKING / NO PARKING ANY TIME | W11-2 | PEDESTRIAN CROSSING |
| R1-1 | STOP | R7-5 | ONE HOUR PARKING 7AM-7PM | W16-7P | BIKE LANE |
| R3-2 | LEFT TURN YIELD | R7-107 | TRUCK STOP | | |
| R3-7L | LEFT LANE MUST TURN LEFT | | | | |

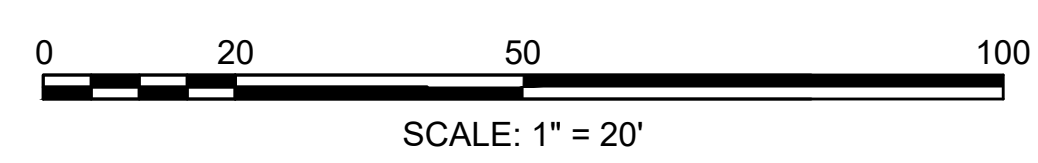

WATERTOWN
ROUTE 16 (MOUNT AUBURN STREET)

| STATE | FED. AID PROJ. NO. | SHEET NO. | TOTAL SHEETS |
|------------------|-----------------------|-----------|--------------|
| MA | STP/CMQ/HSI-0036(017) | 141 | 391 |
| PROJECT FILE NO. | | 607777 | |

TRAFFIC SIGN & PAVEMENT MARKING PLANS
SHEET 15 OF 18

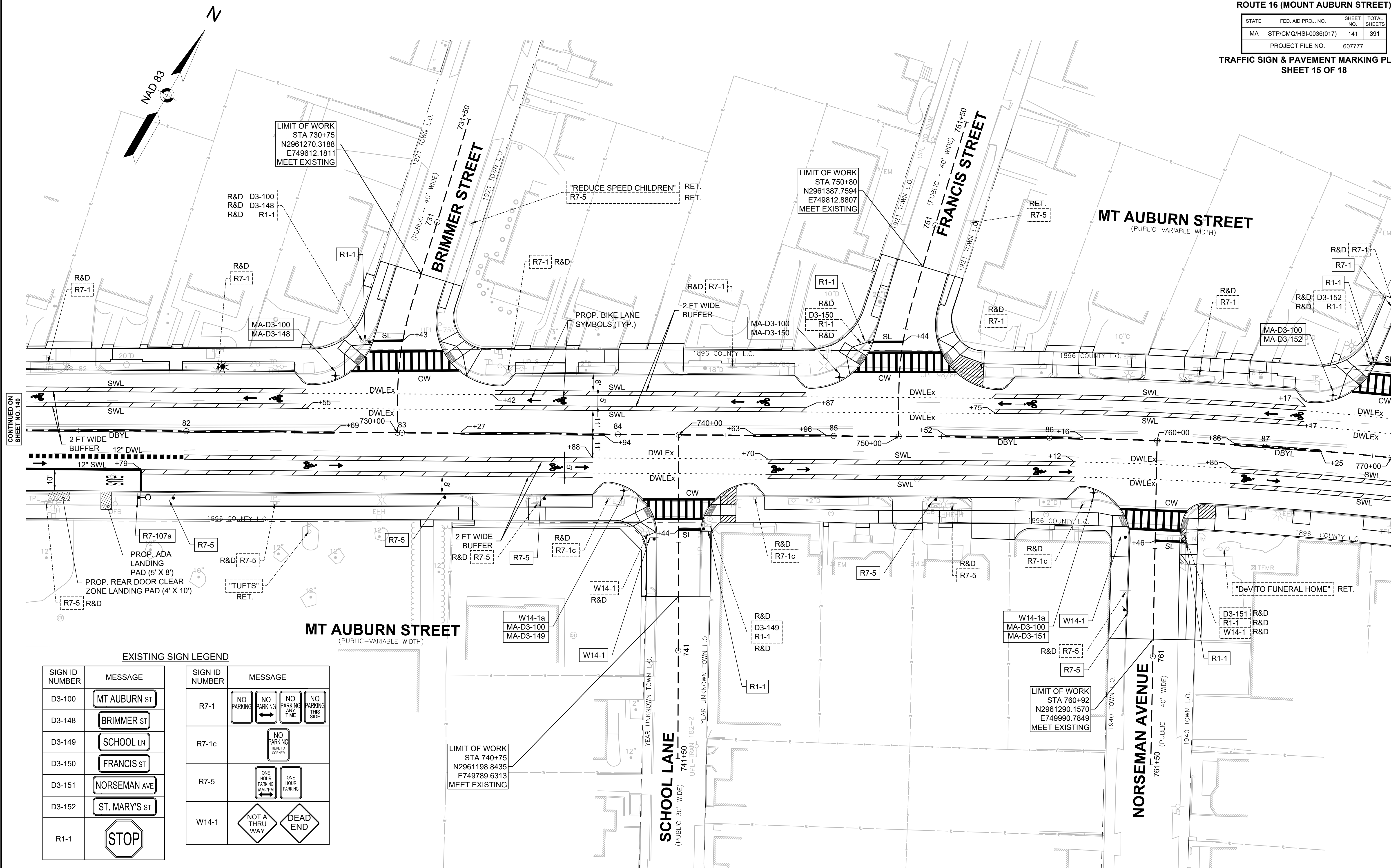

EXISTING SIGN LEGEND

| SIGN ID NUMBER | MESSAGE |
|----------------|---------------|
| D3-100 | MT AUBURN ST |
| D3-148 | BRIMMER ST |
| D3-149 | SCHOOL LN |
| D3-150 | FRANCIS ST |
| D3-151 | NORSEMAN AVE |
| D3-152 | ST. MARY'S ST |
| R1-1 | STOP |

| SIGN ID NUMBER | MESSAGE |
|----------------|---------------------------|
| R7-1 | NO PARKING ANY TIME |
| R7-1c | NO PARKING HERE TO CORNER |
| R7-5 | ONE HOUR PARKING 7AM-7PM |
| W14-1 | NOT A THRU WAY |
| W14-1 | DEAD END |

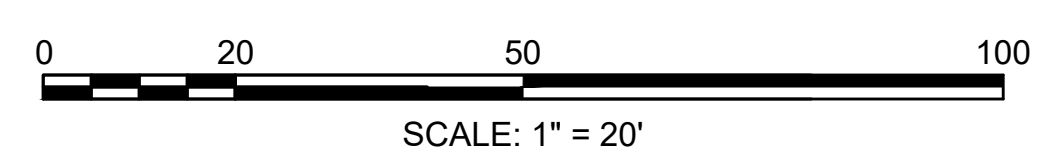

CONTINUED ON SHEET NO. 140

CONTINUED ON SHEET NO. 142

607777_HDP(AVEMENT MARKING PLANS).DWG Plotted on 9/5/2023 6:55 PM

**WATERTOWN
ROUTE 16 (MOUNT AUBURN STREET)**

| STATE | FED. AID PROJ. NO. | SHEET NO. | TOTAL SHEETS |
|-------------------------|-----------------------|-----------|--------------|
| MA | STP/CMQ/HSI-0036(017) | 142 | 391 |
| PROJECT FILE NO. 607777 | | | |

**TRAFFIC SIGN & PAVEMENT MARKING PLANS
SHEET 16 OF 18**

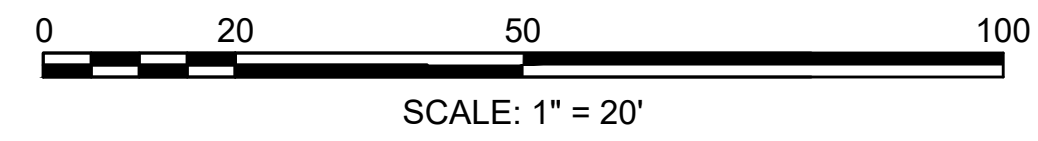
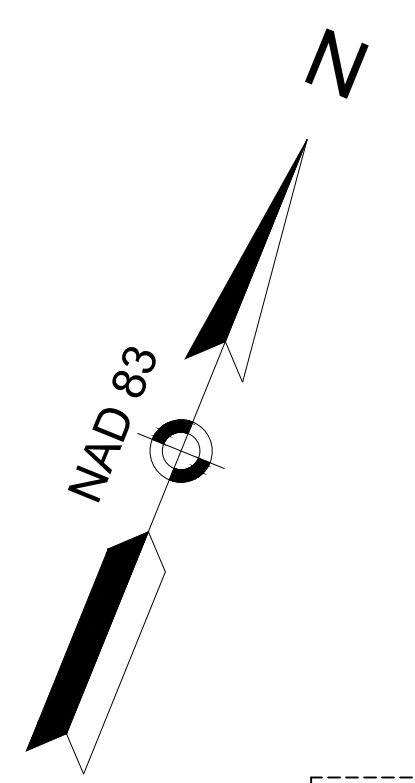
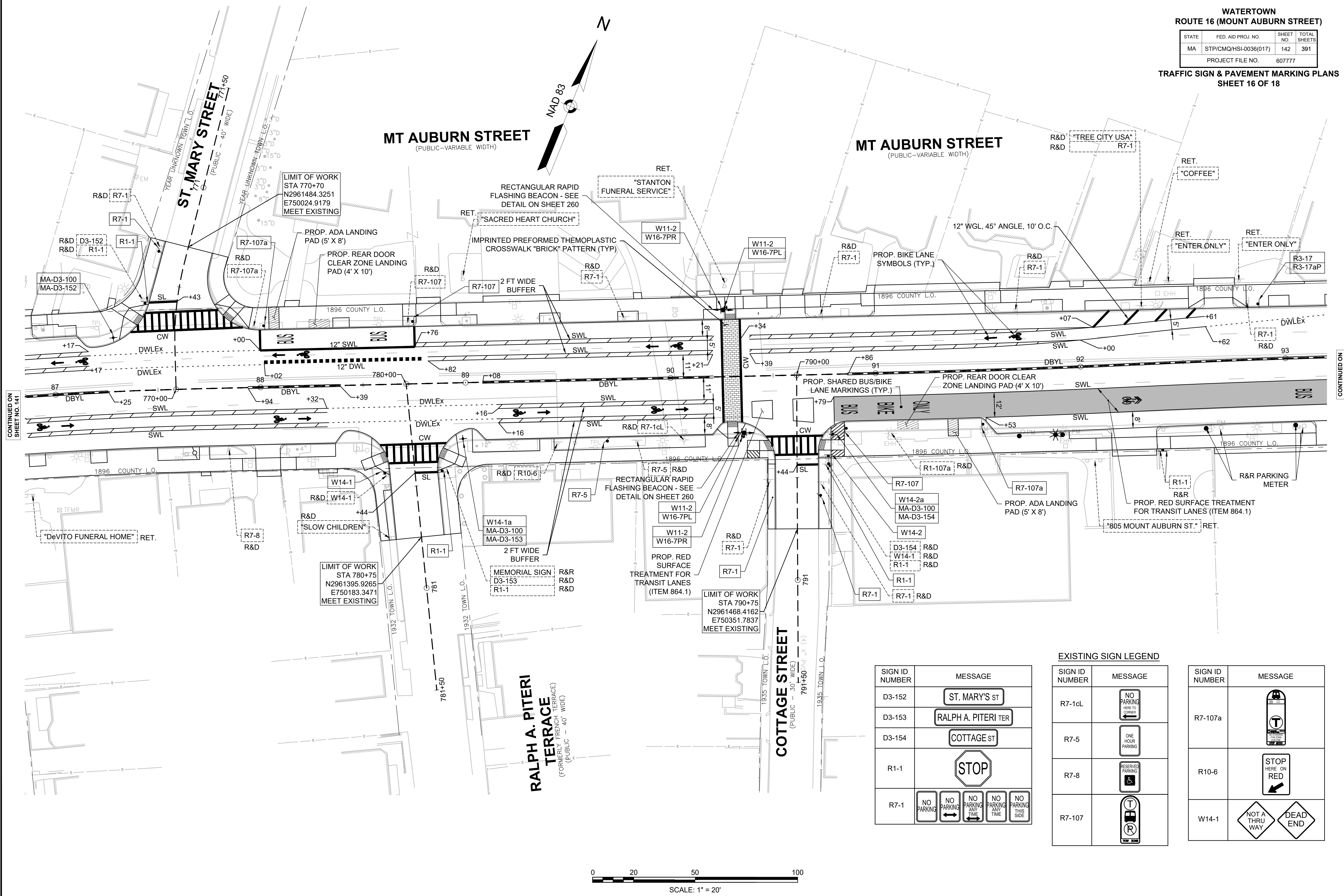

| SIGN ID NUMBER | MESSAGE |
|----------------|---------------------|
| D3-152 | ST. MARY'S ST |
| D3-153 | RALPH A. PITERI TER |
| D3-154 | COTTAGE ST |
| R1-1 | STOP |
| R7-1 | NO PARKING ANY TIME |

EXISTING SIGN LEGEND

| SIGN ID NUMBER | MESSAGE |
|----------------|---------------------------|
| R7-1cL | NO PARKING HERE TO CORNER |
| R7-5 | ONE HOUR PARKING |
| R7-8 | RESERVED PARKING |
| R7-107 | TRANSIT |

| SIGN ID NUMBER | MESSAGE |
|----------------|---------------------------|
| R7-107a | TRANSIT |
| R10-6 | STOP HERE ON RED |
| W14-1 | NOT A THRU WAY / DEAD END |

CONTINUED ON SHEET NO. 141

CONTINUED ON SHEET NO. 143

607777_HDS(PAVEMENT MARKING PLANS).DWG Plotted on 9/5/2023 6:56 PM

**WATERTOWN
ROUTE 16 (MOUNT AUBURN STREET)**

| STATE | FED. AID PROJ. NO. | SHEET NO. | TOTAL SHEETS |
|------------------|-----------------------|-----------|--------------|
| MA | STP/CMQ/HSI-0036(017) | 143 | 391 |
| PROJECT FILE NO. | | 607777 | |

**TRAFFIC SIGN & PAVEMENT MARKING PLANS
SHEET 17 OF 18**

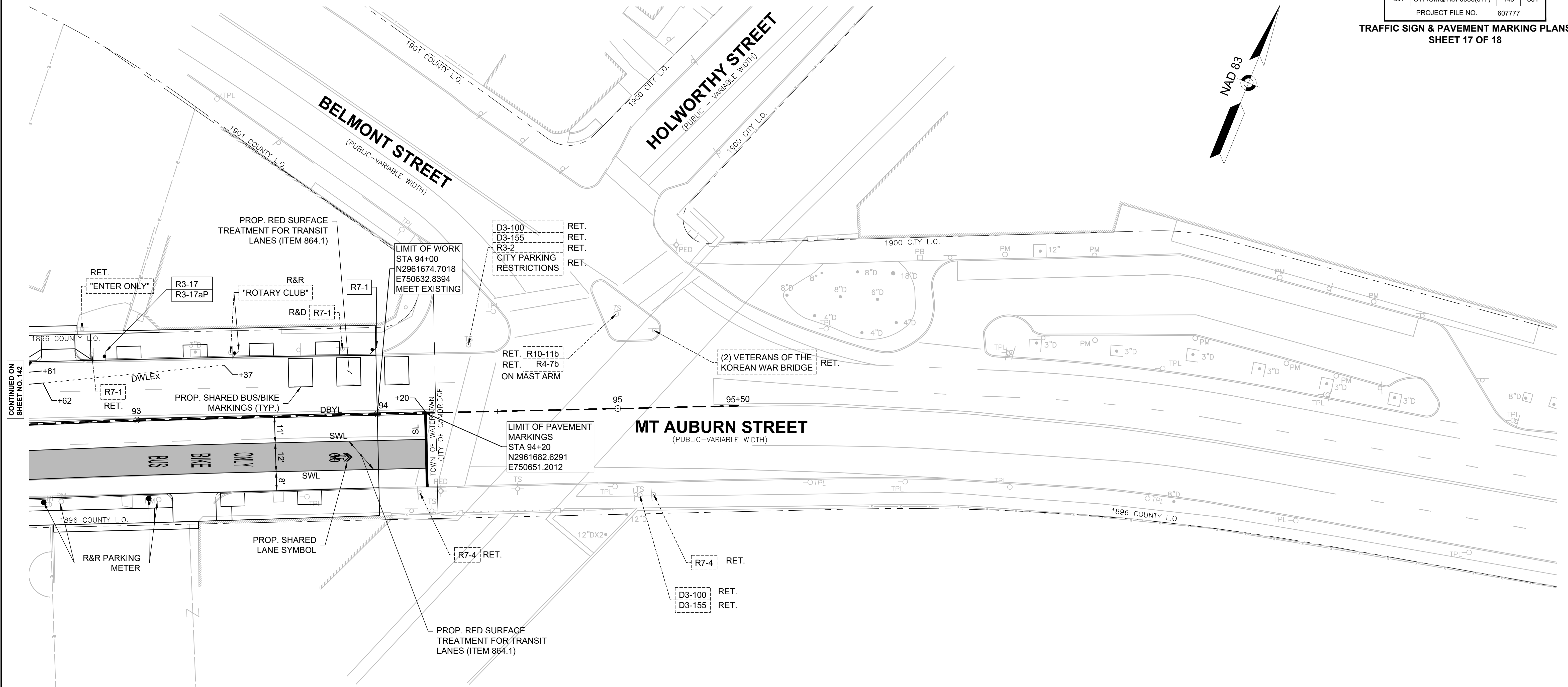
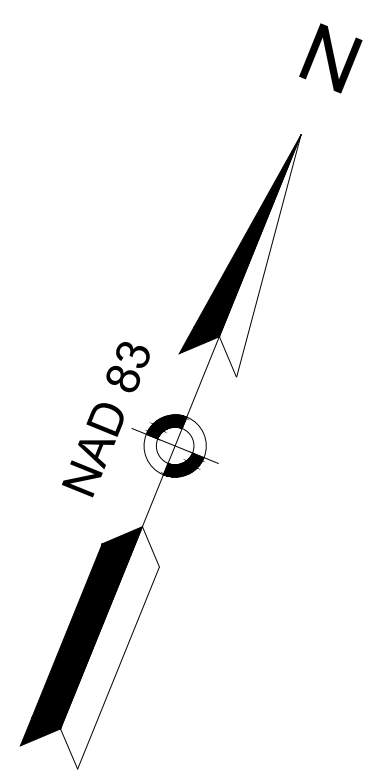

CONTINUED ON
SHEET NO. 142

EXISTING SIGN LEGEND

| SIGN ID NUMBER | MESSAGE | SIGN ID NUMBER | MESSAGE |
|----------------|---------|----------------|---------|
| D3-100 | | R3-2 | |
| D3-155 | | R4-7b | |
| R7-1 | | R10-11b | |
| R7-4 | | | |

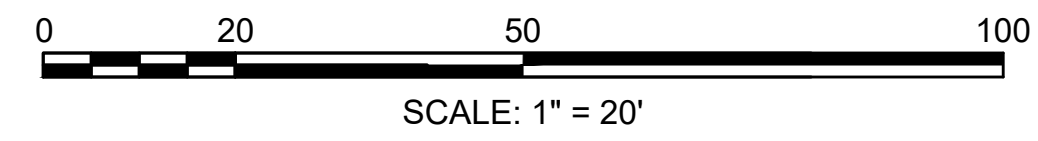

**WATERTOWN
ROUTE 16 (MOUNT AUBURN STREET)**

| STATE | FED. AID PROJ. NO. | SHEET NO. | TOTAL SHEETS |
|-------------------------|-----------------------|-----------|--------------|
| MA | STP/CMQ/HSI-0036(017) | 144 | 391 |
| PROJECT FILE NO. 607777 | | | |

**TRAFFIC SIGN & PAVEMENT MARKING PLANS
SHEET 18 OF 18**

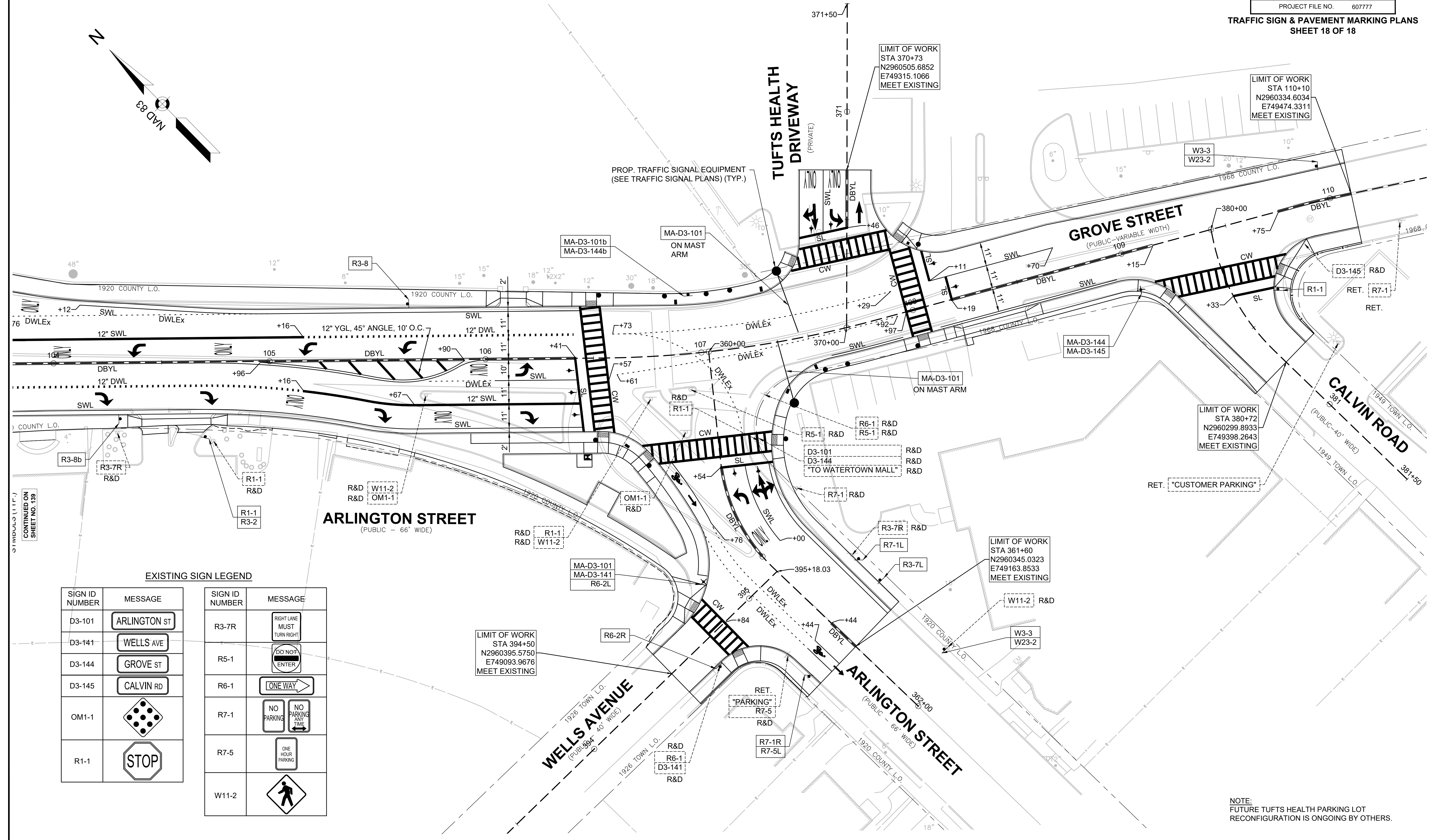
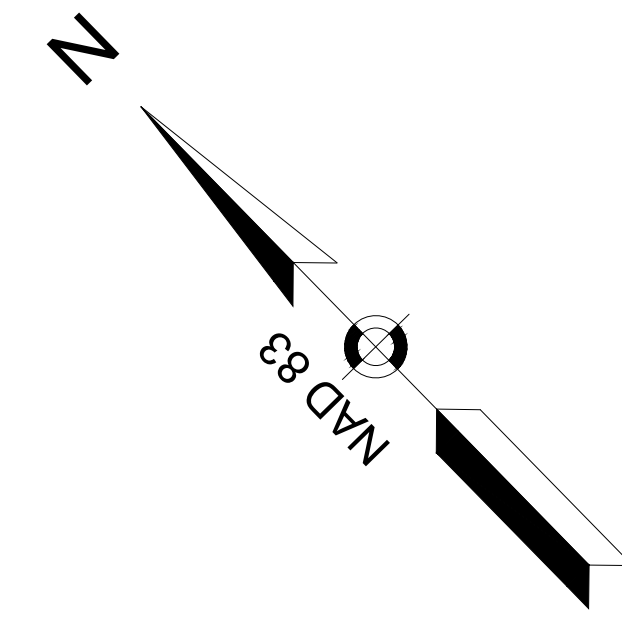

EXISTING SIGN LEGEND

| SIGN ID NUMBER | MESSAGE | SIGN ID NUMBER | MESSAGE |
|----------------|--------------|----------------|----------------------------|
| D3-101 | ARLINGTON ST | R3-7R | RIGHT LANE MUST TURN RIGHT |
| D3-141 | WELLS AVE | R5-1 | DO NOT ENTER |
| D3-144 | GROVE ST | R6-1 | ONE WAY |
| D3-145 | CALVIN RD | R7-1 | NO PARKING |
| OM1-1 | | R7-5 | ONE HOUR PARKING |
| R1-1 | STOP | W11-2 | |

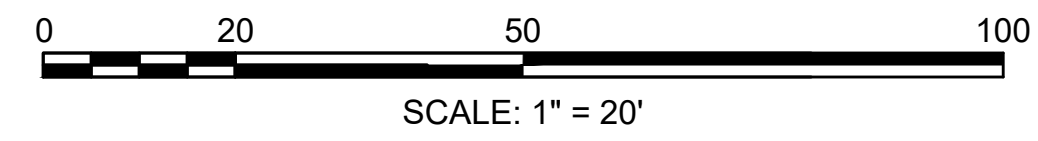

NOTE:
FUTURE TUFTS HEALTH PARKING LOT RECONFIGURATION IS ONGOING BY OTHERS.