

# WATERTOWN, MA. MOUNT AUBURN STREET AT COMMON STREET

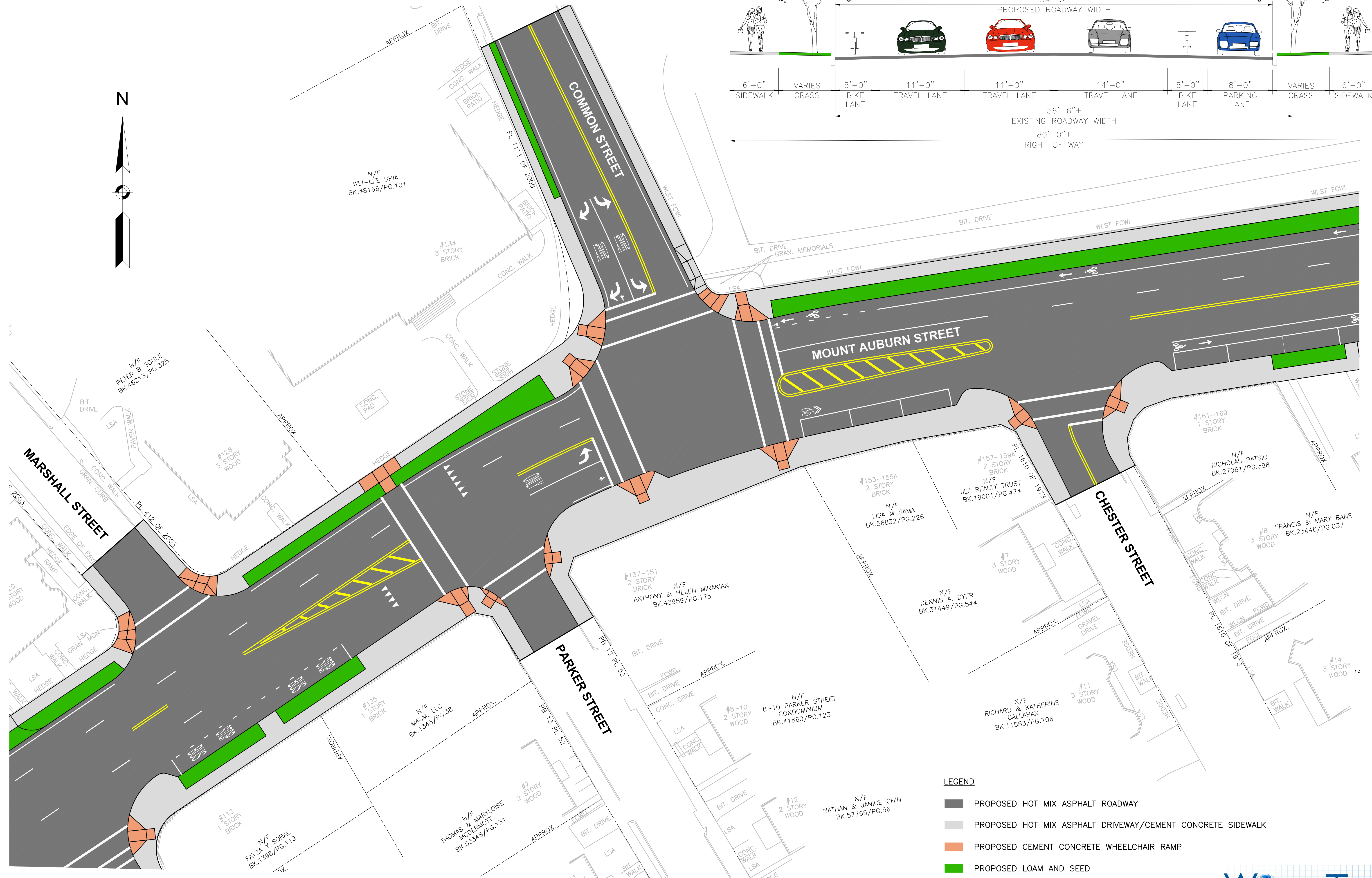

- LEGEND**
- PROPOSED HOT MIX ASPHALT ROADWAY
  - PROPOSED HOT MIX ASPHALT DRIVEWAY/CEMENT CONCRETE SIDEWALK
  - PROPOSED CEMENT CONCRETE WHEELCHAIR RAMP
  - PROPOSED LOAM AND SEED

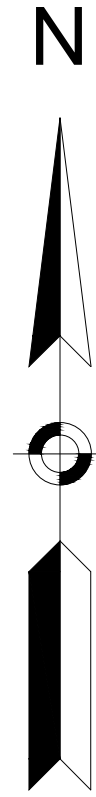
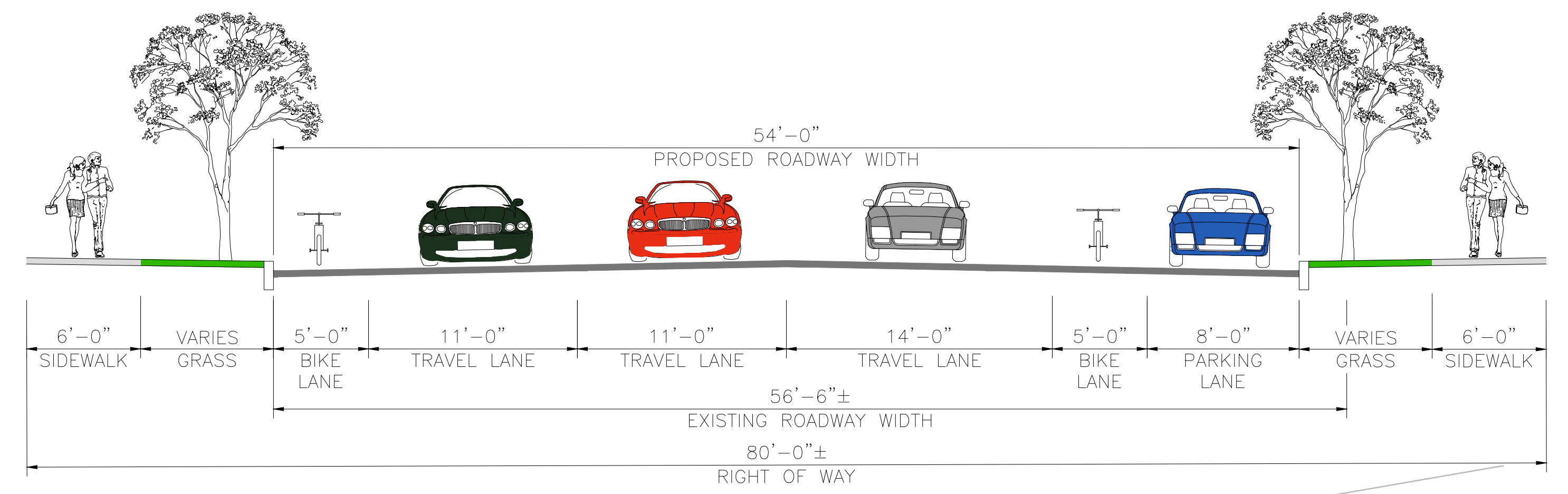